

## Disc Spring for Preloaded Ball Bearing



IIS manufactures all types of Ball bearing Disc Springs both plain and slotted & Preloading Bearing Washers. Ball-Bearing Disc Springs are used with radial Ball bearings to minimize vibration and shaft deflection. Proper preloading will increase bearing rigidity and eliminate excessive wear & tear and running noise.

Special Features of Ball Bearing Disc Springs Preloading Washers :

1. Significant increase or decrease in applied force even with small variation in deflection.
2. Backlash compensation & regressive curves help reduce preload variations changes.
3. Very low force characteristics with very large deflection range.
4. Multiplication of force by stacking of two or more in parallel.
5. Available in all size to accommodate all Ball bearing sizes.
6. Elimination of noise and play in Ball Bearings.
7. Round shape ensures equal distribution of load around the bearing ring.

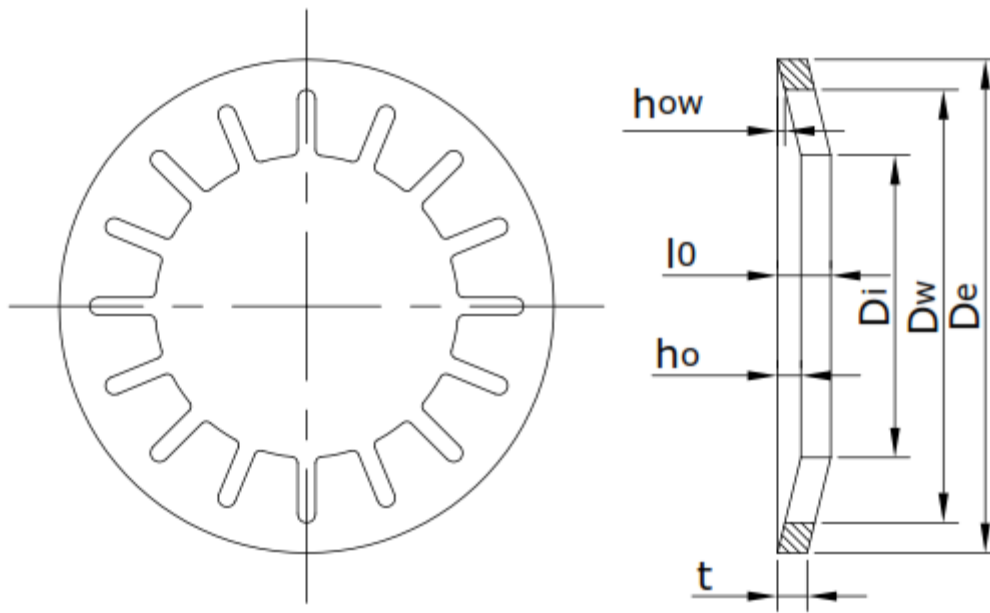

Slotted Type-At IIS, we are engaged in manufacturing, exporting and supplying the top quality **Slotted Ball Bearing Disc Springs**. These springs are commonly used to bear large deflection, backlash compensation, axial preload and minimize degree of stress. Besides, the provided **Slotted Ball Bearing Disc Springs** can be purchased from us at cost effective prices.

In our stock, we have all standard sizes ranging from 9.8 up to 94.5 mm (0.386" - 3.72"). The Slotted Disc Springs have been manufactured for standard Ball Bearing application. These are designed to be fixed around the inside diameter.